

# Blue Ribbon Park

FOLESHILL, COVENTRY CV6 5RB

**PRELIMINARY  
DETAILS**

## To Let NEW INDUSTRIAL/ WAREHOUSE UNITS

**5,500 - 71,500 sq ft (511 - 6,622 sq m)**

### Accommodation

Unit	sq ft	sq m
1	27,500	2,555
2	11,000	1,022
3	11,000	1,022
4	5,500	511
5	16,500	1,533

### Specification

- Eaves from 8.6 to 9.6m
- Insulated sectional electrically operated loading doors
- Insulated clad walls with internal blockwork to 2.4m height
- All mains services
- First floor offices including heating and lighting
- Dedicated parking and loading areas
- Secure landscaped estate

### Terms

Rent and Lease term information available upon request.

### Location

- Located on Canal Road just off A444.
- Junction 3 M6 only 1 mile.
- Coventry City Centre 1.5 miles.
- Established Commercial location.
- Nearby occupiers include: Lidl, The Royal Mail Sorting Office and Vauxhall dealership.

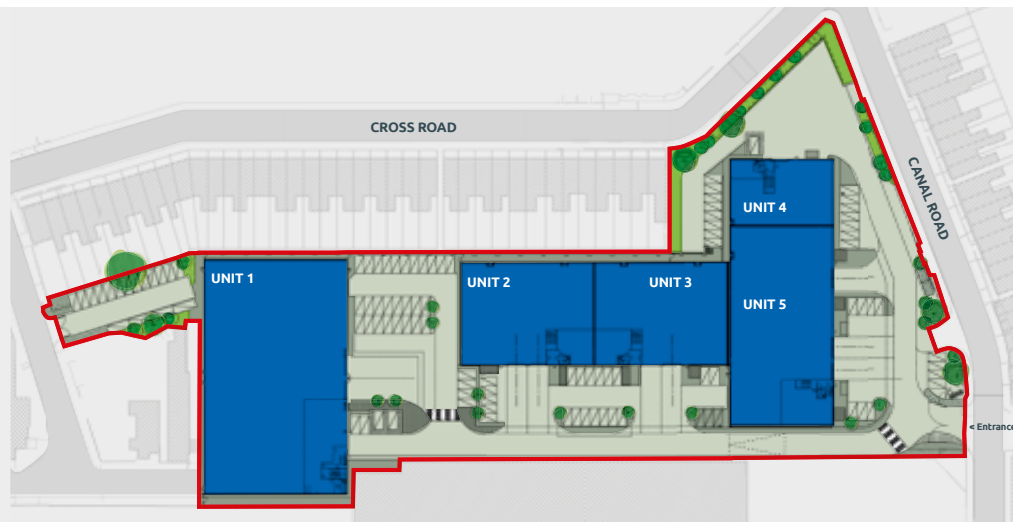

**For further information contact:**

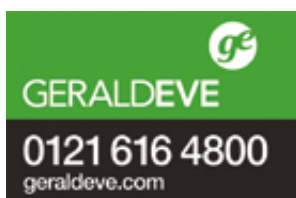

**Jon Ryan-Gill**  
JRyan-Gill@geraldev.com



**Andrew Cosnett**  
andrew.cosnett@bromwichhardy.com

**Blue Ribbon Park**  
FOLESHILL, COVENTRY CV6 5RB

